



Subminiature Pushbutton Switches

Specifications:

Contact rating:	max. 48 V AC/DC, 0.4 VA / max. 50 mA min. 20 mV AC/DC, 1 μ A
Contact resistance:	< 50 m Ω
Insulation resistance:	> 500 M Ω at 250 V DC
Dielectric strength:	500 V, 50 Hz for the duration of 1 minute
Operating temperature:	-20 °C to +85 °C
Mechanical life:	minimum 60000 operations
Contacts:	phosphor bronze, gold-plated over nickel barrier
Terminals:	APE – PC terminals, crimped, phosphor bronze, gold-plated over nickel barrier
Material:	case: PBT, meets UL 94 V-0, washable metal parts: brass, nickel-plated
Mounting:	on pc-board
Soldering conditions:	wave-soldering – max. 5 sec, 260 °C \pm 5 °C

Models: Switching functions: when looking at the brand name, the normally closed contact is on the right-hand side

washable

SPDT

APE 1 F

on - mom

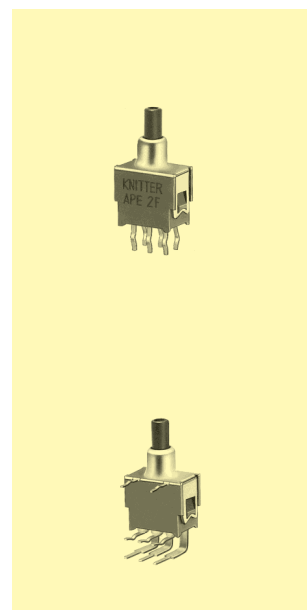
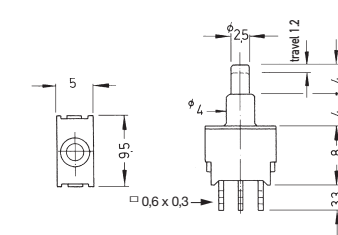
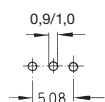

DPDT

APE 2 F

on - mom

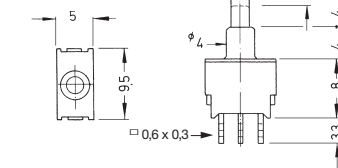
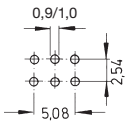

SPDT

APE 1 F - RA

on - mom

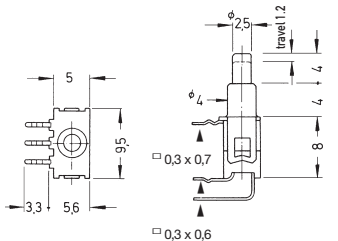
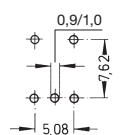

DPDT

APE 2 F - RA

on - mom

